

**Futtertype:
Berg KF 400**

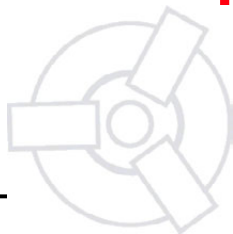

Weiche Aufsatzbacke mit Spitzverzahnung 3/32°90°, Nut=25,5mm

Nutenstein: X6838

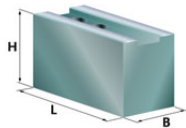

B	H	L	kg/Satz	Typ	Ident-Nr.	Werkstoff
60	60	140	9,4	RE40	202015	16MnCr5
60	90	155	16,3	RD40	201025	16MnCr5
60	90	155	6,5	RD40A	209004	Aluminium

Ausführung: Rohlinge, ungebohrt

Nutenstein: X6838

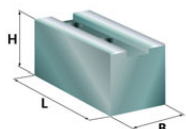

B	H	L	kg/Satz	Typ	Ident-Nr.	Werkstoff
60	60	140	11,4	RC05	200101	16MnCr5
60	80	140	5,2	RC10	200102	16MnCr5
64	102	155	21,2	RC15	200103	C15
64	127	155	25,8	RC20	200104	C15
64	152	155	30,6	RC25	200105	C15
80	60	140	15,3	RC30	200106	16MnCr5
80	80	140	21,0	RC35	200107	C15
102	64	140	19,5	RC40	200108	16MnCr5
100	100	155	35,3	RC85	200117	16MnCr5

Weiche Segment-Aufsatzbacke

Ausführung

Nutenstein: X6838

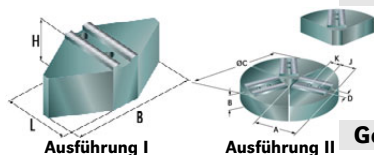

B	H	L	kg/Satz	Typ	Ident-Nr.	Werkstoff
280	76	152		I CM40	208006	C15
280	76	152		I HL40	210007	Aluminium
Ø400	76	177		II BN27	211105	C15
Ø400	76	177		II BN29	211205	Aluminium

Gehärtete Greiferspannbacken, Außenspannung

Nutenstein: X6838

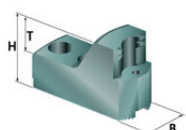

B	H	T	kg/Satz	Typ	Ident-Nr.	Werkstoff
60	79	33				
Spannbereiche ca.						
55- 138mm			9,0	ID06	228017	16MnCr5
137- 226mm			6,3	ID13	228018	16MnCr5
222- 312mm			4,8	ID21	228019	16MnCr5
310- 402mm			6,6	ID30	228020	16MnCr5

Gehärtete Greiferspannbacken, Innenspannung

Nutenstein: X6838

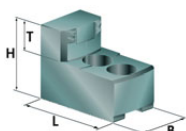

B	H	T	kg/Satz	Typ	Ident-Nr.	Werkstoff
60	79	33				
Spannbereiche ca.						
97- 184mm			8,6	JD10	230011	16MnCr5
172- 263mm			6,7	JD17	230012	16MnCr5
251- 342mm			4,0	JD25	230013	16MnCr5
330- 421mm			6,0	JD33	230014	16MnCr5

Gehärtete umkehrbare Aufsatzbacken

Nutenstein: X6838

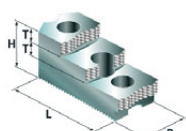

B	H	L	T	Typ	Ident-Nr.	Werkstoff
60	75	126	18	GY40	221025	16MnCr5

Nutensteine

H	h	G	Typ	Ident-Nr.	Werkstoff
36	16	M20	X6838	9906838	40NiCrMo6

Auflagebolzen

G	H	SW	Typ	Ident-Nr.	Werkstoff
M8	5	13	IU05	229008	C15
M8	10	13	IU10	229009	C15
M8	15	13	IU15	229010	C15
M8	20	13	IU20	229011	C15
M8	25	13	IU25	229012	C15

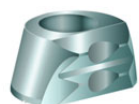
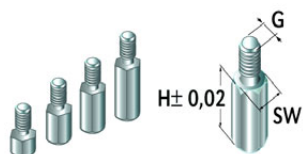
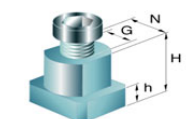

Gripper Hartmetall



Ausdrehvorrichtung



Stangengreifer

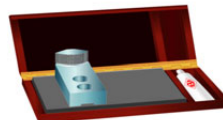

Reinigungsplatte



Pendelbacken

**Futtertype:
Berg KF 500**



Markenspannbacken

Weiche Aufsatzbacke mit Spitzverzahnung 3/32°90°, Nut=25,5mm **Nutenstein: X6838**

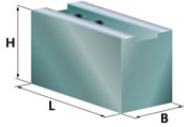

B	H	L	kg/Satz	Typ	Ident-Nr.	Werkstoff
60	60	140	9,4	RE40	202015	16MnCr5
60	90	155	16,3	RD40	201025	16MnCr5
60	90	155	6,5	RD40A	209004	Aluminium

Ausführung: Rohlinge, ungebohrt **Nutenstein: X6838**

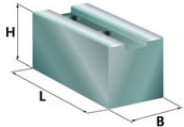

60	60	140	11,4	RC05	200101	16MnCr5
60	80	140	5,2	RC10	200102	16MnCr5
64	102	155	21,2	RC15	200103	C15
64	127	155	25,8	RC20	200104	C15
64	152	155	30,6	RC25	200105	C15
80	60	140	15,3	RC30	200106	16MnCr5
80	80	140	21,0	RC35	200107	C15
102	64	140	19,5	RC40	200108	16MnCr5
100	100	155	35,3	RC85	200117	16MnCr5

Weiche Segment-Aufsatzbacke **Nutenstein: X6838**

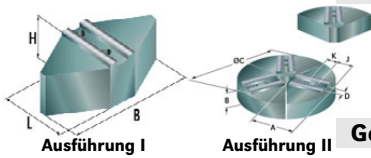

			Ausführung			
280	76	152	I	CM40	208006	C15
280	76	152	I	HL40	210007	Aluminium
Ø400	76	177	II	BN27	211105	C15
Ø400	76	177	II	BN29	211205	Aluminium

Gehärtete Greiferspannbacken, Außenspannung **Nutenstein: X6838**

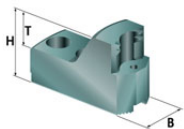

B	H	T	kg/Satz	Typ	Ident-Nr.	Werkstoff
60	79	33				
Spannbereiche ca.						
72- 237mm			9,0	ID06	228017	16MnCr5
157- 325mm			6,3	ID13	228018	16MnCr5
242- 412mm			4,8	ID21	228019	16MnCr5
331- 502mm			6,6	ID30	228020	16MnCr5

Gehärtete Greiferspannbacken, Innenspannung **Nutenstein: X6838**

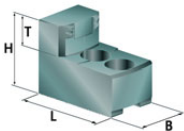

B	H	T	kg/Satz	Typ	Ident-Nr.	Werkstoff
60	79	33				
Spannbereiche ca.						
116- 283mm			8,6	JD10	230011	16MnCr5
193- 363mm			6,7	JD17	230012	16MnCr5
271- 442mm			4,0	JD25	230013	16MnCr5
351- 522mm			6,0	JD33	230014	16MnCr5

Gehärtete umkehrbare Aufsatzbacken **Nutenstein: X6838**

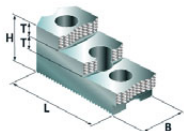

B	H	L	T	Typ	Ident-Nr.	Werkstoff
60	75	126	18	GY40	221025	16MnCr5

Nutensteine

H	h	G	Typ	Ident-Nr.	Werkstoff
36	16	M20	X6838	9906838	40NiCrMo6

Auflagebolzen

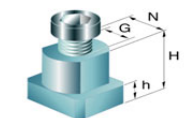

G	H	SW	Typ	Ident-Nr.	Werkstoff
M8	5	13	IU05	229008	C15
M8	10	13	IU10	229009	C15
M8	15	13	IU15	229010	C15
M8	20	13	IU20	229011	C15
M8	25	13	IU25	229012	C15

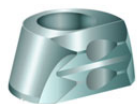
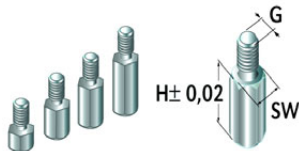

Gripper Hartmetall



Ausdrehvorrichtung



Stangengreifer



Reinigungsplatte



Pendelbacken

**Futtertype:
Berg KF 630**

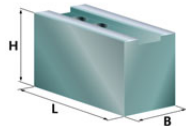
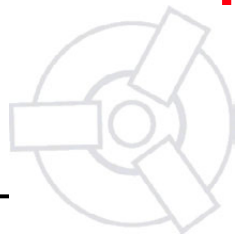

Weiche Aufsatzbacke mit Spitzverzahnung 3/32°90°, Nut=25,5mm						Nutenstein: X6838	
B	H	L	kg/Satz	Typ	Ident-Nr.	Werkstoff	
60	60	140	9,4	RE40	202015	16MnCr5	
60	90	155	16,3	RD40	201025	16MnCr5	
60	90	155	6,5	RD40A	209004	Aluminium	

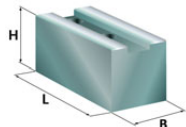

Ausführung: Rohlinge, ungebohrt						Nutenstein: X6838	
B	H	L	kg/Satz	Typ	Ident-Nr.	Werkstoff	
60	60	140	11,4	RC05	200101	16MnCr5	
60	80	140	5,2	RC10	200102	16MnCr5	
64	102	155	21,2	RC15	200103	C15	
64	127	155	25,8	RC20	200104	C15	
64	152	155	30,6	RC25	200105	C15	
80	60	140	15,3	RC30	200106	16MnCr5	
80	80	140	21,0	RC35	200107	C15	
102	64	140	19,5	RC40	200108	16MnCr5	
100	100	155	35,3	RC85	200117	16MnCr5	

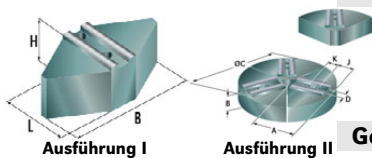

Weiche Segment-Aufsatzbacke			Ausführung		Nutenstein: X6838		
B	H	L	I	Typ	Ident-Nr.	Werkstoff	
280	76	152	I	CM40	208006	C15	
280	76	152	I	HL40	210007	Aluminium	
Ø400	76	177	II	BN27	211105	C15	
Ø400	76	177	II	BN29	211205	Aluminium	

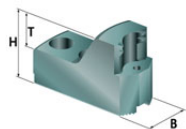

Gehärtete Greiferspannbacken, Außenspannung						Nutenstein: X6838	
B	H	T	kg/Satz	Typ	Ident-Nr.	Werkstoff	
60	79	33					
Spannbereiche ca.							
109- 370mm			9,0	ID06	228017	16MnCr5	
195- 458mm			6,3	ID13	228018	16MnCr5	
282- 546mm			4,8	ID21	228019	16MnCr5	
371- 636mm			6,6	ID30	228020	16MnCr5	

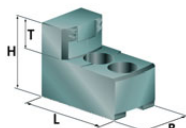

Gehärtete Greiferspannbacken, Innenspannung						Nutenstein: X6838	
B	H	T	kg/Satz	Typ	Ident-Nr.	Werkstoff	
60	79	33					
Spannbereiche ca.							
154- 416mm			8,6	JD10	230011	16MnCr5	
232- 496mm			6,7	JD17	230012	16MnCr5	
311- 576mm			4,0	JD25	230013	16MnCr5	
390- 655mm			6,0	JD33	230014	16MnCr5	

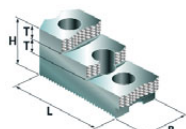

Gehärtete umkehrbare Aufsatzbacken						Nutenstein: X6838	
B	H	L	T	Typ	Ident-Nr.	Werkstoff	
60	75	126	18	GY40	221025	16MnCr5	

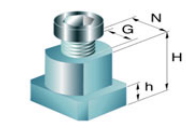

Nutensteine					
H	h	G	Typ	Ident-Nr.	Werkstoff
36	16	M20	X6838	9906838	40NiCrMo6

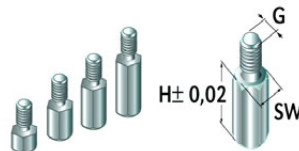

Auflagebolzen					
G	H	SW	Typ	Ident-Nr.	Werkstoff
M8	5	13	IU05	229008	C15
M8	10	13	IU10	229009	C15
M8	15	13	IU15	229010	C15
M8	20	13	IU20	229011	C15
M8	25	13	IU25	229012	C15

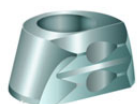

Gripper Hartmetall



Ausdrehvorrichtung



Stangengreifer

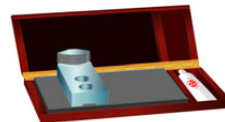

Reinigungsplatte



Pendelbacken