

**Futtertype:  
Forkardt KSH 160**

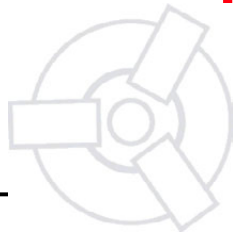

**Markenspannbacken**

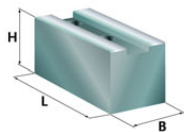
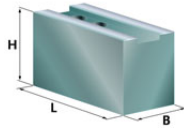

<b>Weiche Aufsatzbacke mit Spitzverzahnung 1/16°90°</b>					<b>Nutenstein: GG20</b>		
B	H	L	kg/Satz	Typ	Ident-Nr.	Werkstoff	
40	40	80	2,0	RE16	203001	16MnCr5	
40	60	70	3,1	RD16	201010	16MnCr5	
40	60	70	1,1	RD16A	209001	Aluminium	

<b>Ausführung: angeschrägt</b>					<b>Nutenstein: GG20</b>		
40	60	70	2,0	RH16	203001	16MnCr5	

<b>Ausführung: Rohlinge, ungebohrt</b>					<b>Nutenstein: GG20</b>		
35	50	70	2,7	RA05	200001	16MnCr5	
40	40	105	3,6	RA20	200004	16MnCr5	
40	60	70	3,8	RA25	200005	16MnCr5	
40	60	105	5,4	RA31	200019	16MnCr5	
40	80	90	6,4	RA40	200008	C15	
40	100	90	8,1	RA45	200009	C15	
40	120	90	9,9	RA50	200010	C15	
50	80	105	9,3	RA60	200012	16MnCr5	
60	60	90	7,2	RA70	200014	16MnCr5	
60	80	90	9,45	RA80	200016	16MnCr5	
60	100	90	12,5	RA85	200017	16MnCr5	

<b>Weiche Segment-Aufsatzbacke</b>				<b>Ausführung</b>		<b>Nutenstein: GG20</b>	
120	60	60	9,0	I	CM16	208001	C15
120	64	64	3,2	I	HL16	210001	Aluminium
Ø169	76	76		II	BN77	211101	Stahl
Ø169	76	76		II	BN79	211201	Aluminium

<b>Gehärtete Greiferspannbacken, Außenspannung</b>					<b>Nutenstein: GG16</b>		
B	H	T	kg/Satz	Typ	Ident-Nr.	Werkstoff	
40	49	20					
<b>Spannbereich</b>							
34- 45mm			1,8	IA03	228001	16MnCr5	
40- 64mm			1,4	IA05	228002	16MnCr5	
57- 85mm			1,5	IA07	228003	16MnCr5	
78- 107mm			1,6	IA09	228004	16MnCr5	
97- 130mm			1,5	IA11	228005	16MnCr5	

<b>Gehärtete Greiferspannbacken, Innenspannung</b>					<b>Nutenstein: GG16</b>		
B	H	T	kg/Satz	Typ	Ident-Nr.	Werkstoff	
40	49	20					
<b>Spannbereich</b>							
55- 65mm			1,7	JA05	230001	16MnCr5	
62- 87mm			1,6	JA07	230002	16MnCr5	
82- 108mm			1,5	JA09	230003	16MnCr5	
97- 130mm			1,5	JA11	230004	16MnCr5	

<b>Gehärtete umkehrbare Aufsatzbacken</b>					<b>Nutenstein: GG16</b>		
B	H	L	T	Typ	Ident-Nr.	Werkstoff	
35	49	72,5	12	GY16	221005	16MnCr5	

<b>Nutensteine</b>			<b>Ausführung</b>		<b>Nutenstein: GG16</b>		
H	h	J	G	Typ	Ident-Nr.	Werkstoff	
23	9	22 f. weiche Backen	M12	I	GG20	288001	40NiCrMo6
23	9	19 f. harte Backen	M12	I	GG16	288002	40NiCrMo6
23	9	—	M12	II	GN16	287002	40NiCrMo6

<b>Auflagebolzen</b>			<b>Nutenstein: GG16</b>			
G	H	SW	Typ	Ident-Nr.	Werkstoff	
M6	5	10	IT05	229004	C15	
M6	10	10	IT10	229005	C15	
M6	15	10	IT15	229006	C15	
M6	20	10	IT20	229007	C15	

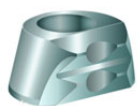
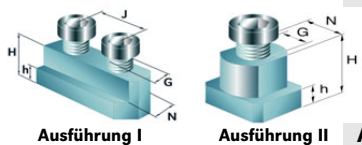
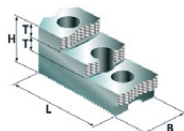
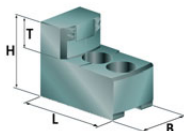
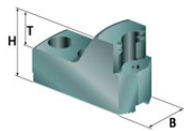
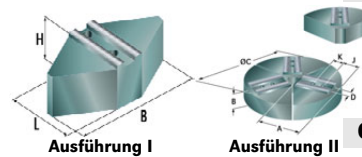

**Gripper Hartmetall**



**Ausdrehvorrichtung**



**Stangengreifer**

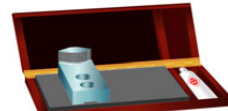

**Reinigungsplatte**



**Pendelbacken**

Weitere Abmessungen und Sonderspannbacken auf Anfrage. Weitere Datenblätter auf Anfrage.  
**Irrtümer und Änderungen vorbehalten.**

**Futtertype:  
Forkardt KSH 200**



**Markenspannbacken**

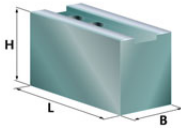

<b>Weiche Aufsatzbacke mit Spitzverzahnung 1/16°90°</b>					<b>Nutenstein: GG20</b>		
B	H	L	kg/Satz	Typ	Ident-Nr.	Werkstoff	
40	40	90	2,7	RE20	202005	16MnCr5	
40	60	90	4,2	RD20	201015	16MnCr5	
40	60	90	1,5	RD20A	209002	Aluminium	



<b>Ausführung: angeschrägt</b>					<b>Nutenstein: GG20</b>		
35	40	98	2,7	RH20	203005	16MnCr5	

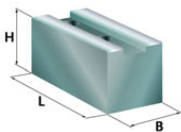

<b>Ausführung: Rohlinge, ungebohrt</b>					<b>Nutenstein: GG20</b>		
35	50	70	2,7	RA05	200001	16MnCr5	
40	40	105	3,6	RA20	200004	16MnCr5	
40	60	70	3,8	RA25	200005	16MnCr5	
40	60	105	5,4	RA31	200019	16MnCr5	
40	80	90	6,4	RA40	200008	C15	
40	100	90	8,1	RA45	200009	C15	
40	120	90	9,9	RA50	200010	C15	
50	80	105	9,3	RA60	200012	16MnCr5	
60	60	90	7,2	RA70	200014	16MnCr5	
60	80	90	9,45	RA80	200016	16MnCr5	
60	100	90	12,5	RA85	200017	16MnCr5	

<b>Weiche Segment-Aufsatzbacke</b>			<b>Ausführung</b>		<b>Nutenstein: GG20</b>		
150	64	76	14,0	I	CM20	208002	C15
150	64	76	5,0	I	HL20	210003	Aluminium
Ø210	76	95		II	BN87	211102	C15
Ø210	76	95		II	BN89	211202	Aluminium

<b>Gehärtete Greiferspannbacken, Außenspannung</b>					<b>Nutenstein: GG20</b>		
B	H	T	kg/Satz	Typ	Ident-Nr.	Werkstoff	
40	49	20					
<b>Spannbereich</b>							
47- 76mm			1,8	IA03	228001	16MnCr5	
66- 94mm			1,4	IA05	228002	16MnCr5	
88- 117mm			1,5	IA07	228003	16MnCr5	
110- 139mm			1,6	IA09	228004	16MnCr5	
132- 162mm			1,5	IA11	228005	16MnCr5	

<b>Gehärtete Greiferspannbacken, Innenspannung</b>					<b>Nutenstein: GG20</b>		
B	H	T	kg/Satz	Typ	Ident-Nr.	Werkstoff	
40	49	20					
<b>Spannbereich</b>							
68- 96mm			1,7	JA05	230001	16MnCr5	
90- 119mm			1,6	JA07	230002	16MnCr5	
111- 140mm			1,5	JA09	230003	16MnCr5	
132- 162mm			1,5	JA11	230004	16MnCr5	

<b>Gehärtete umkehrbare Aufsatzbacken</b>					<b>Nutenstein: GG16</b>		
B	H	L	T	Typ	Ident-Nr.	Werkstoff	
40	49	73,5	12	GY20	221010	16MnCr5	

<b>Nutensteine</b>			<b>Ausführung</b>		<b>Nutenstein: GG20</b>		
H	h	J	G	Typ	Ident-Nr.	Werkstoff	
23	9	22 f.weiche Backen	M12	I	GG20	288001	40NiCrMo6
23	9	19 f.harte Backen	M12	I	GG16	288002	40NiCrMo6
23	9	—	M12	II	GN16	287002	40NiCrMo6

<b>Auflagebolzen</b>					<b>Nutenstein: GG20</b>		
G	H	SW	Typ	Ident-Nr.	Werkstoff		
M6	5	10	IT05	229004	C15		
M6	10	10	IT10	229005	C15		
M6	15	10	IT15	229006	C15		
M6	20	10	IT20	229007	C15		

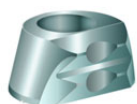
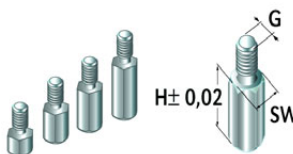
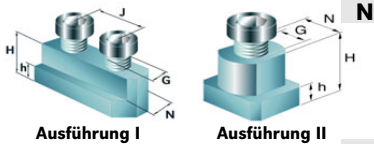
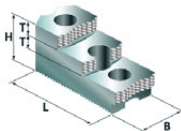
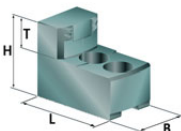
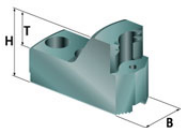
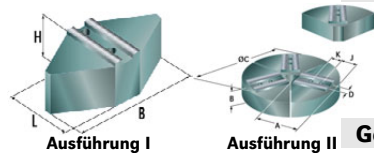

**Gripper Hartmetall**



**Ausdrehvorrichtung**



**Stangengreifer**

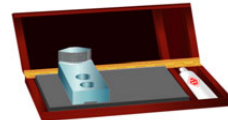

**Reinigungsplatte**



**Pendelbacken**

**Futtertype:  
Forkardt KSH 250**

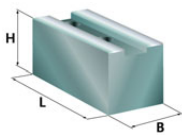
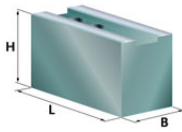
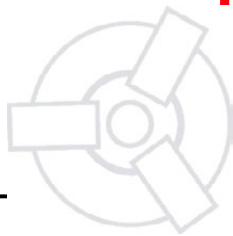

<b>Weiche Aufsatzbacke mit Spitzverzahnung 1/16°90°, Nut=21mm</b>					<b>Nutenstein: GG32</b>		
B	H	L	kg/Satz	Typ	Ident-Nr.	Werkstoff	
50	50	120	5,1	RE25	202010	16MnCr5	
50	80	120	9,3	RD25	201020	16MnCr5	
50	80	120	3,3	RD25A	209003	Aluminium	
<b>Ausführung: angeschrägt</b>					<b>Nutenstein: GG32</b>		
50	50	140	9,4	RH32	203015	16MnCr5	
<b>Ausführung: Rohlinge, ungebohrt</b>					<b>Nutenstein: GG32</b>		
45	60	90	6,8	RB10	200052	16MnCr5	
50	50	90	5,1	RB15	200053	16MnCr5	
50	80	90	8,3	RB25	200055	16MnCr5	
60	60	90	7,3	RB35	200057	16MnCr5	
60	60	105	8,5	RB40	200058	16MnCr5	
60	80	90	9,9	RB45	200059	16MnCr5	
60	80	120	13,2	RB55	200061	16MnCr5	
64	102	120	16,8	RB60	200062	C15	
64	127	120	20,4	RB65	200063	C15	
80	60	120	13,2	RB70	200064	16MnCr5	

<b>Weiche Segment-Aufsatzbacke</b>			<b>Ausführung</b>		<b>Nutenstein: GG32</b>		
B	H	L	kg/Satz	Typ	Ident-Nr.	Werkstoff	
240	76	118	28,0	I	CM32	C15	
240	76	118	10,0	I	HL32	Aluminium	
Ø304	76	133		II	BN24	C15	
Ø304	76	133		II	BN26	Aluminium	

<b>Gehärtete Greiferspannbacken, Außenspannung</b>					<b>Nutenstein: GG25</b>		
B	H	T	kg/Satz	Typ	Ident-Nr.	Werkstoff	
50	59	25					
<b>Spannbereiche ca.</b>							
34- 54mm			3,9	IC04	228012	16MnCr5	
40- 88mm			3,3	IC05	228013	16MnCr5	
80- 133mm			2,7	IC08	228014	16MnCr5	
129- 183mm			2,4	IC13	228015	16MnCr5	
179- 234mm			2,8	IC18	228016	16MnCr5	

<b>Gehärtete Greiferspannbacken, Innenspannung</b>					<b>Nutenstein: GG25</b>		
B	H	T	kg/Satz	Typ	Ident-Nr.	Werkstoff	
50	59	25					
<b>Spannbereiche ca.</b>							
81- 106mm			3,9	JC08	230008	16MnCr5	
106- 160mm			2,8	JC10	230009	16MnCr5	
156- 211mm			2,7	JC15	230010	16MnCr5	

<b>Gehärtete umkehrbare Aufsatzbacken</b>					<b>Nutenstein: GG25</b>		
B	H	L	T	Typ	Ident-Nr.	Werkstoff	
50	59	103,5	14	GY25	221015	16MnCr5	

<b>Nutensteine</b>			<b>Ausführung</b>		<b>Nutenstein: GG25</b>		
H	h	J	G	Typ	Ident-Nr.	Werkstoff	
27	11	25 f.harte Backen	M16	I	GG25	288004 40NiCrMo6	
27	11	28 f.weiche Backen	M16	I	GG32	288003 40NiCrMo6	
27	11	—	M16	II	GN25	287003 40NiCrMo6	

<b>Auflagebolzen</b>			<b>Nutenstein: GG25</b>			
G	H	SW	Typ	Ident-Nr.	Werkstoff	
M8	5	13	IT05	229008	C15	
M8	10	13	IT10	229009	C15	
M8	15	13	IT15	229010	C15	
M8	20	13	IT20	229011	C15	
M8	25	13	IT25	229012	C15	

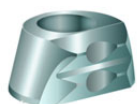
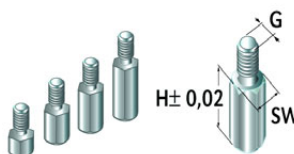
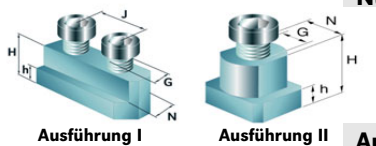
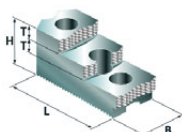
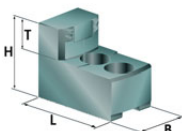
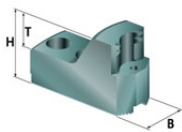
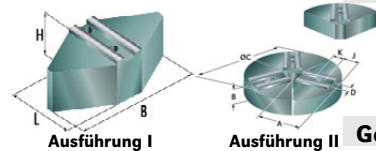

**Gripper Hartmetall**



**Ausdrehvorrichtung**



**Stangengreifer**

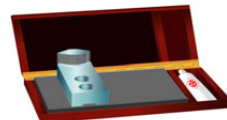

**Reinigungsplatte**



**Pendelbacken**

**Futtertype:  
Forkardt KSH 315**

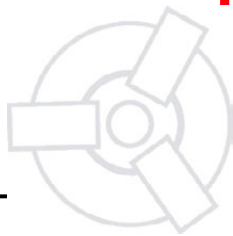

**Markenspannbacken**

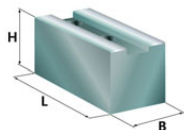
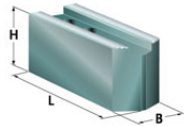
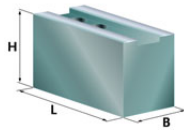

<b>Weiche Aufsatzbacke mit Spitzverzahnung 1/16°90°</b>					<b>Nutenstein: GG32</b>		
B	H	L	kg/Satz	Typ	Ident-Nr.	Werkstoff	
50	50	120	5,1	RE25	202010	16MnCr5	
50	80	120	9,3	RD25	201020	16MnCr5	
50	80	120	3,3	RD25A	209003	Aluminium	

<b>Ausführung: angeschragt</b>					<b>Nutenstein: GG32</b>		
50	50	140	9,4	RH32	203015	16MnCr5	

<b>Ausführung: Rohlinge, ungebohrt</b>					<b>Nutenstein: GG32</b>		
45	60	90	6,8	RB10	200052	16MnCr5	
50	50	90	5,1	RB15	200053	16MnCr5	
50	80	90	8,3	RB25	200055	16MnCr5	
60	60	90	7,3	RB35	200057	16MnCr5	
60	60	105	8,5	RB40	200058	16MnCr5	
60	80	90	9,9	RB45	200059	16MnCr5	
60	80	120	13,2	RB55	200061	16MnCr5	
64	102	120	16,8	RB60	200062	C15	
64	127	120	20,4	RB65	200063	C15	
80	60	120	13,2	RB70	200064	16MnCr5	

<b>Weiche Segment-Aufsatzbacke</b>				<b>Ausführung</b>		<b>Nutenstein: GG32</b>	
240	76	118	28,0	I	CM32	208005	C15
240	76	118	10,0	I	HL32	210006	Aluminium
Ø304	76	133		II	BN24	211104	C15
Ø304	76	133		II	BN26	211204	Aluminium

<b>Gehärtete Greiferspannbacken, Außenspannung</b>					<b>Nutenstein: GG25</b>		
B	H	T	kg/Satz	Typ	Ident-Nr.	Werkstoff	
50	59	25					
<b>Spannbereich</b>							
34- 112mm			3,9	IC04	228012	16MnCr5	
40- 147mm			3,3	IC05	228013	16MnCr5	
80- 192mm			2,7	IC08	228014	16MnCr5	
128- 244mm			2,4	IC13	228015	16MnCr5	
179- 295mm			2,8	IC18	228016	16MnCr5	

<b>Gehärtete Greiferspannbacken, Innenspannung</b>					<b>Nutenstein: GG25</b>		
B	H	T	kg/Satz	Typ	Ident-Nr.	Werkstoff	
50	59	25					
<b>Spannbereich</b>							
81- 166mm			3,9	JC08	230008	16MnCr5	
105- 220mm			2,8	JC10	230009	16MnCr5	
155- 271mm			2,7	JC15	230010	16MnCr5	

<b>Gehärtete umkehrbare Aufsatzbacken</b>					<b>Nutenstein: GG25</b>		
B	H	L	T	Typ	Ident-Nr.	Werkstoff	
50	59	103,5	14	GY25	221015	16MnCr5	

<b>Nutensteine</b>				<b>Ausführung</b>			
H	h	J	G	Typ	Ident-Nr.	Werkstoff	
27	11	25 f.harte Backen	M16	I	GG25	288004 40NiCrMo6	
27	11	28 f.weiche Backen	M16	I	GG32	288003 40NiCrMo6	
27	11	—	M16	II	GN25	287003 40NiCrMo6	

<b>Auflagebolzen</b>					
G	H	SW	Typ	Ident-Nr.	Werkstoff
M8	5	13	IT05	229008	C15
M8	10	13	IT10	229009	C15
M8	15	13	IT15	229010	C15
M8	20	13	IT20	229011	C15
M8	25	13	IT25	229012	C15

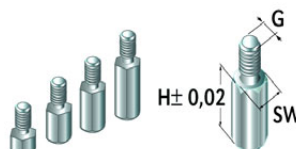
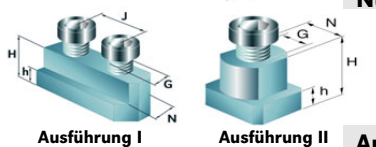
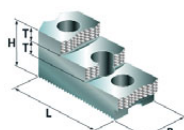
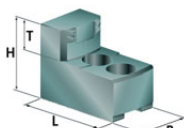
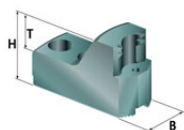
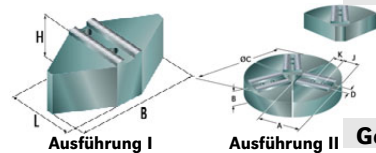

**Gripper Hartmetall**



**Ausdrehvorrichtung**



**Stangengreifer**

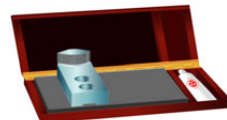

**Reinigungsplatte**



**Pendelbacken**

**Futtertype:  
Forkardt KSH 400**



**Markenspannbacken**

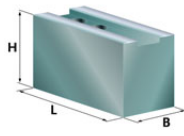

**Weiche Aufsatzbacke mit Spitzverzahnung 1/16°90°**

B	H	L	kg/Satz	Typ	Ident-Nr.	Werkstoff
50	50	120	5,1	RE25	202010	16MnCr5
50	80	120	9,3	RD25	201020	16MnCr5
50	80	120	3,3	RD25A	209003	Aluminium

**Nutenstein: GG32**

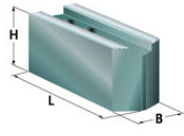

**Ausführung: angeschrägt**

50	50	140	9,4	RH32	203015	16MnCr5
----	----	-----	-----	------	--------	---------

**Nutenstein: GG32**

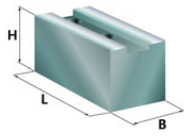

**Ausführung: Rohlinge, ungebohrt**

B	H	L	kg/Satz	Typ	Ident-Nr.	Werkstoff
45	60	90	6,8	RB10	200052	16MnCr5
50	50	90	5,1	RB15	200053	16MnCr5
50	80	90	8,3	RB25	200055	16MnCr5
60	60	90	7,3	RB35	200057	16MnCr5
60	60	105	8,5	RB40	200058	16MnCr5
60	80	90	9,9	RB45	200059	16MnCr5
60	80	120	13,2	RB55	200061	16MnCr5
64	102	120	16,8	RB60	200062	C15
64	127	120	20,4	RB65	200063	C15
80	60	120	13,2	RB70	200064	16MnCr5

**Nutenstein: GG32**

**Weiche Segment-Aufsatzbacke**

**Ausführung**

B	H	L	kg/Satz	Ausführung	Typ	Ident-Nr.	Werkstoff
240	76	118	28,0	I	CM32	208005	C15
240	76	118	10,0	I	HL32	210006	Aluminium
Ø304	76	133		II	BN24	211104	C15
Ø304	76	133		II	BN26	211204	Aluminium

**Nutenstein: GG32**

**Gehärtete Greiferspannbacken, Außenspannung**

B	H	T	kg/Satz	Typ	Ident-Nr.	Werkstoff
50	59	25				
<b>Spannbereich</b>						
34- 195mm			3,9	IC04	228012	16MnCr5
40- 230mm			3,3	IC05	228013	16MnCr5
80- 275mm			2,7	IC08	228014	16MnCr5
128- 327mm			2,4	IC13	228015	16MnCr5
179- 379mm			2,8	IC18	228016	16MnCr5

**Nutenstein: GG25**

**Gehärtete Greiferspannbacken, Innenspannung**

B	H	T	kg/Satz	Typ	Ident-Nr.	Werkstoff
50	59	25				
<b>Spannbereich</b>						
81- 250mm			3,9	JC08	230008	16MnCr5
105- 303mm			2,8	JC10	230009	16MnCr5
155- 355mm			2,7	JC15	230010	16MnCr5

**Nutenstein: GG25**

**Gehärtete umkehrbare Aufsatzbacken**

B	H	L	T	Typ	Ident-Nr.	Werkstoff
50	59	103,5	14	GY25	221015	16MnCr5

**Nutenstein: GG25**

**Nutensteine**

**Ausführung**

H	h	J	G	Typ	Ident-Nr.	Werkstoff
27	11	25 f.harte Backen	M16	I	GG25	288004
27	11	28 f.weiche Backen	M16	I	GG32	288003
27	11	—	M16	II	GN25	287003

**Auflagebolzen**

G	H	SW	Typ	Ident-Nr.	Werkstoff
M8	5	13	IT05	229008	C15
M8	10	13	IT10	229009	C15
M8	15	13	IT15	229010	C15
M8	20	13	IT20	229011	C15
M8	25	13	IT25	229012	C15

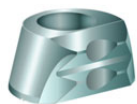
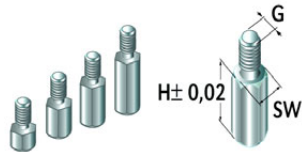
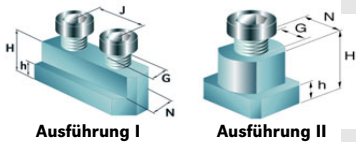
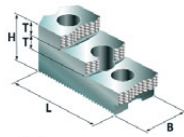
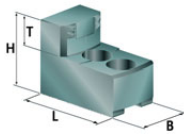
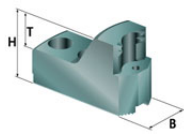
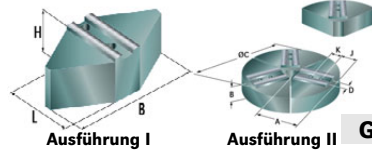

**Gripper Hartmetall**



**Ausdrehvorrichtung**



**Stangengreifer**

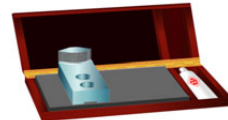

**Reinigungsplatte**



**Pendelbacken**